

# XTERIOR INSULATION MASONRY VENEER SYSTEM

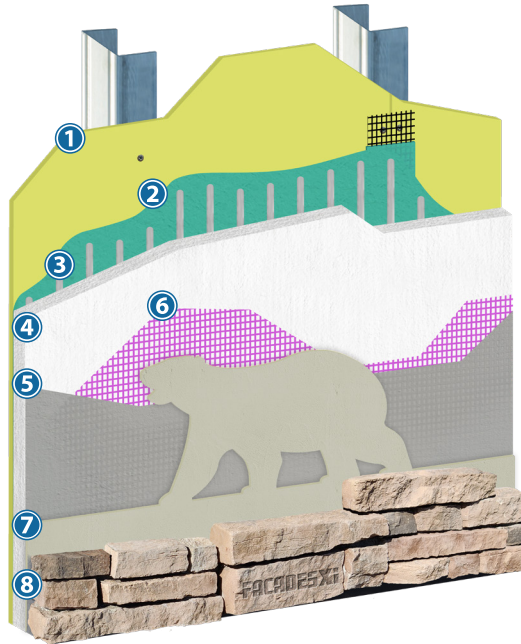

## SYSTEM DESCRIPTION

Our Xterior Insulation Masonry Veneer System is a tested, warranted, code compliant and engineered masonry veneer system with monolithic water and air barrier coating and accessory materials, internal drainage, continuous Xterior Insulation, and adhered masonry veneers. Available with either EPS or XPS, this insulated system gives the design aesthetics of a stone, brick or tile wall with the advantages of a lightweight system, decreasing installation time and structure costs.

### Optional Advantages Upgrades

- XPS Xterior Insulation for higher R Value per inch

## COMPONENTS

- ❶ **Substrate**
  - ASTM C1177 glass mat faced sheathing
  - ASTM C1325 Type A Exterior cement-board
  - Exposure I or exterior plywood sheathing (grade C-D or better)
  - Exposure I OSB
  - Poured concrete/unit masonry/brick
- ❷ **WaterShield Water and Air Barrier Assembly**
  - WaterShield Water & Air Barrier
  - WaterShield Flashing Tape
  - WaterShield Joint Mesh
  - FXI FlashFill
- ❸ **Means of Drainage / Insulation Board Attachment**
  - Vertical Ribbons of Adhesive
- ❹ **Continuous Insulation**
  - Styrofoam™ Panel Core 20 (no substitutions)
  - 1 pcf Expanded Polystyrene
- ❺ **Base Coat**
  - Xi-Acrylic Base Coat
  - Xi-Dry Acrylic Base Coat
- ❻ **Reinforcing Mesh**
  - Xi-Mesh
  - Xi-Mesh10
- ❼ **Adhered Veneer Mortar**
  - Xi-Masonry Veneer Mortar
- ❽ **Veneer Units**
  - Manufactured Stone Veneer
  - Natural Stone Veneer
  - Thin Brick
  - Tiles

*Note: Adhered Veneers are not to exceed 36 inches in any face dimension, 5 square feet in total face areas, 2-5/8 inches thick or 15 pounds per square foot*

*Consult system specifications for exact component options.*

## USES

Exterior, new, retrofit, residential, multi-family, commercial, panelized, institutional, hotels, hospitals, retail centers, schools, condominiums, and government facilities. High Impact Systems Available.

## COMPLIANCE / APPROVALS

Xterior Insulation Masonry Veneer System is installed in conformance with:

- International Building Code
- International Residential Code
- ASTM E2568
- ASTM E2570
- ASTM E2273
- ICC Acceptance Criteria 235
- ICC Acceptance Criteria 212
- ASHRAE 90.1
- NFPA 268
- NFPA 285

## ADVANTAGES

- Xi-WaterShield provides an enhanced water and air barrier for envelope protection.
- Continuous Insulation outperforms cavity insulation and gives greater energy savings.
- Impact resistant systems available.
- Mold and mildew resistant finishes.
- Unlimited color and design aesthetics.
- Labor costs and time savings.
- Single source warranty.
- Lower cladding weight for decreased structural requirements.
- Non-combustible and fire resistant assemblies are available.
- High-strength mortar for secure attachment.

## DESIGN CONSIDERATIONS

- All products must be installed in accordance with current Evaluation Report.
- Maximum allowable deflection  $L/240$ .
- The design wind load shall be determined by the Evaluation Report or per the structural engineer.
- Wood-based sheathing should be gapped 1/8 inch.
- All penetrations shall be properly treated, flashed and/or sealed using approved installation designed for water drainage to the exterior of the wall.
- Expansion joints are per project design. See Specifications and details for expansion joint locations.
- Sealant joints shall be detailed and installed per sealant manufacturer's recommendations.
- Slope is required on all horizontal surfaces greater than 1".

## LIMITATIONS

- Ambient and surface temperature must remain above 40°F (4°C) during and for 24 hours after set has occurred.
- Protect applied product from inclement weather until dry.
- Fire-rated and noncombustible assemblies must be per the current Evaluation Report.
- System must terminate above grade per the current Evaluation Report.
- No additives are permitted to any components unless specifically approved by FXI.
- Follow the application instructions for each component.
- Use only on surfaces that are sound, dry, clean, unpainted, and free from any residue that may affect the ability of the FACADESXi Products to bond.
- Xi-Watershield should not be left exposed more than 6 months.
- For use on vertical above grade walls only.
- Maintenance Required: follow adhered veneer manufacturers' recommendations.

This system bulletin is not to be used as an application guide. See System specifications, details, and product datasheets for specific installation information.

Xterior Insulation Masonry Veneer System SB 06/22/2022